



**1 PLAN VIEW OF SOUTH LAKE ACCESS**

**NOTES**

LAKE ACCESS SHALL UTILIZE A GATE SYSTEM AND BARRIER POSTS TO RESTRICT BOAT LAUNCHING FROM MEMORIAL DAY TO LABOR DAY.

THE SOUTH ACCESS SHALL BE USED EXCLUSIVELY FOR BEACH RELATED ACTIVITIES AND THE GATES CLOSED WHEN THE ACCESS IS RESTRICTED.

SIGNS ILLUSTRATING HOURS OF OPERATION, WHICH MATCH THE BALDWIN TOWNSHIP ADOPTED PARK ORDINANCE, SHALL BE POSTED.

ADDITIONAL SIGNAGE MAY BE REQUIRED WHICH INFERS THE BEACH IS A "SWIM AT YOUR OWN RISK" BEACH AND NO LIFE GUARD IS ON DUTY.

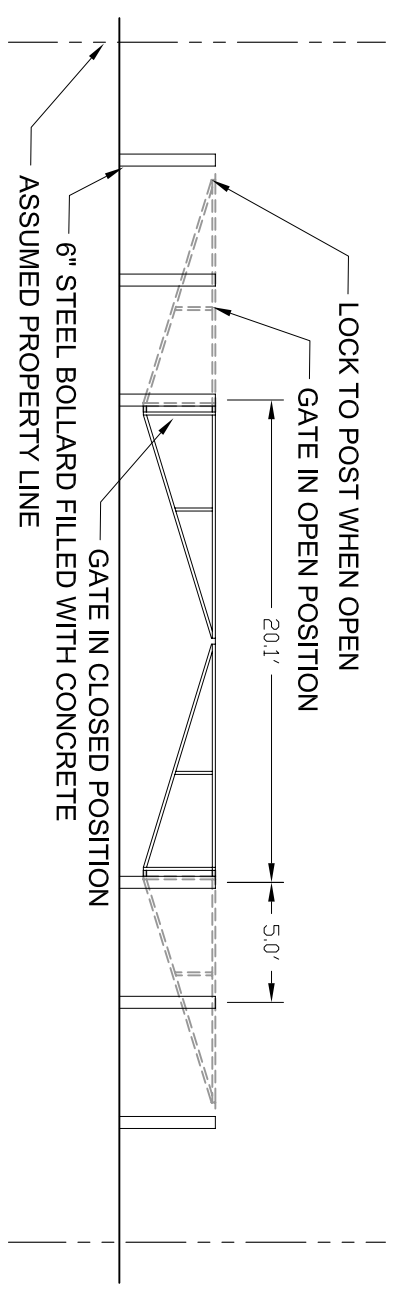

**1 ELEVATION OF PROPOSED GATE**

**PLA** Patten Landscape Architecture, LLC.  
Princeton, MN  
Phone: 763-350-3913

I hereby certify that this plan was prepared by me or under my direct supervision and that I am a duly Licensed Landscape Architect under the laws of the State of Minnesota.  
David W. Patten  
Date: \_\_\_\_\_ Lic. No.: 41458

SURVEYED	-
DESIGNED	DWP
DRAWN	DWP
CHECKED	DWP

**Baldwin Township**

SANDY LAKE SOUTH ACCESS  
Baldwin Township, MN  
**CONCEPT SITE PLAN**

PROJECT NUMBER: NA	DATE: October 6, 2008
SHEET NUMBER: <b>1</b>	

Call 48 Hours before digging  
GOPHER STATE ONE CALL  
Twin Cities Area 651-454-0002  
MN, Toll Free 1-800-252-1166

